

Audrey Silverstein - FTS
3620 Cemetery Lane
Westminster, MD 21158

410-868-6369 • dinosmommie@yahoo.com

For more info and our coursing schedule, please visit our websites:

www.hanoverlurecoursingclubs.com
www.asfaregion8.com

Directions to Hanover Shoe Farms, Sells Station Road Site:

From West or South: Rt. 97 to Littlestown. At the traffic light take Rt. 194 North to Sell Station Road. Left on Sell Station; 1.3 miles to site.

From East and North: Rt. 194 South out of Hanover. Sells Station Road is 0.8 miles past the main entrance to Hanover Shoe Farms. Turn right on Sell Station; 1.3 miles to the site.

General Site Descriptions: The Sells Station Road soccer complex is fenced and remote from busy roads. The weather may be hot, and field conditions vary from dry through wet and muddy. Please provide shade and water for your hounds.

Map of area:

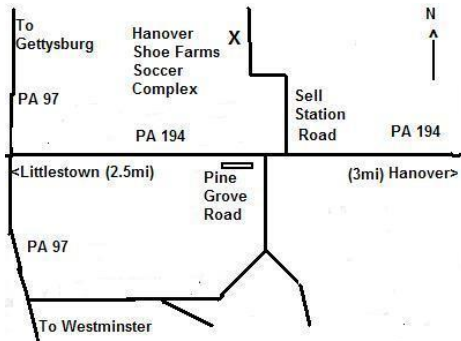

Motels:

Travelodge, Gettysburg PA 717-334-9281
Boston Inn, Westminster, MD 800-634-0846
1863 Inn of Gettysburg, Gettysburg, PA 717-334-6211
Comfort Inn, Gettysburg, PA 717-337-2400
Super 8-Gettysburg, Gettysburg, PA 717-337-1400
Motel 6, York, PA 717-846-6260
Econolodge, Hanover, PA 717-646-1000

PREMIUM LIST

EARLY ENTRIES CLOSE: March 9, 2017, 6pm
at the FTS's address: 3620 Cemetery La, Westminster, MD 21158
DAY OF TRIAL ENTRIES CLOSE 30 minutes prior to roll call
at the FTS's Car



TORTOISE & HARE LURE COURSERS Region 8 ASFA ALL-BREED FIELD TRIALS

March 11th & 12th, 2017

**Hanover Soccer Complex
Sells Station Rd.
Littlestown, PA 17340**

Cell Phone on site: 410-868-6369
Early-entry fee \$18.00 for the first hound entered;
\$15.00 for additional hounds from the same household.
Day of Trial Entry \$25 each
Hound Certifications \$10 each

T&HLC appreciates the continuing generosity of The Hanover Shoe Farms Inc. for permitting the use of their Soccer Complex for this event.

Permission has been granted by the American Sighthound Field Association for the holding of this event under ASFA Rules and Regulations. *Audrey Silverstein, Chairperson, ASFA Scheduling Committee*

Go to www.ASFA.org
for online Rulebook, Policies, Contacts, Clubs,
Trial Schedules, Trial Results & much more.

Tortoise & Hare Lure Coursers

Pat Wieland...**President** Celeste Mulcrone...**Vice President**
 Sally MacDowell...**Secretary** Audrey Silverstein ...**Treasurer**
Directors: Sally Mac Dowell, Beth Anne Haner, Den Wright

JUDGES & ASSIGNMENTS

Francis Byrne, P.O. Box 248 Clear Spring MD 21722
 Bob Marciszewski, 11330 Glen Arm Rd, Glen Arm, MD 21057
 Dean Wright, 446 Baltimore St, Hanover, PA 17331

S = Single Judge * = Provisional Judge X= Multiple Judges

Saturday

| Judges | Af | A Z | B A | B Z | C | G | I B | I G | I W | P H | R R | S A | S D | S L | S W | W | Ltd | Sgl |
|---------|----|--------|--------|--------|---|---|--------|--------|--------|--------|--------|--------|--------|--------|--------|---|-----|-----|
| Francis | S | S | S | | | | | | | | | | | | | | S | S |
| Bob | | | | S | S | S | S | S | S | S | S | | | | | | | |
| Dean | | | | | | | | | | | | S | S | S | S | S | | |

Sunday

| Judges | Af | A Z | B A | B Z | C | G | I B | I G | I W | P H | R R | S A | S D | S L | S W | W | Ltd | Sgl |
|---------|----|--------|--------|--------|---|---|--------|--------|--------|--------|--------|--------|--------|--------|--------|---|-----|-----|
| Francis | | | | | | | S | S | S | S | S | | | | | | | |
| Bob | | | | | | | | | | | | S | S | S | S | S | S | S |
| Dean | S | S | S | S | S | S | | | | | | | | | | | | |

FIELD COMMITTEE

| | |
|-----------------------|--|
| Field Trial Chairman | Sally MacDowell, 11330 Glen Arm Rd, Glen Arm, MD 21057, sallybmac@verizon.net 443-690-4862 |
| Field Trial Secretary | Audrey Silverstein, 3620 Cemetery La, Westminster, MD 21158, 410-868-6369, dinosmommie@yahoo.com |
| Lure Operators | Dean Wright, Harry VanVliet, John Arvin, Borzoi Bob, Don Ewing, Bob Jordan |
| Field Clerks | Audrey Silverstein |
| Huntmasters | Borzoi Bob, Beth Ann Haner, Pat Wieland, John Arvin, Francis Byrne |
| Inspection | Nancy Ewing, Bonnie Loudon |

TRIAL HOURS: 7:30am UNTIL AFTER RIBBONS ARE AWARDED.

Day of Trial entries close at 8:00am

Substitutions (same owner) until 8:00am day of trial

ROLL CALL: PROMPTLY at 8:30am

**ENTRIES WILL NOT BE ACKNOWLEDGED BY RETURN
MAIL OR PHONE**

Ribbons or rosettes will be offered for all placements.

First=Blue, Second=Red, Third=Yellow, Fourth=White, NBQ=Green

**Highest Scoring Single=Navy/Gold, Best of Breed=Purple/Gold,
& Best in Field=Red, White & Blue.**

ELIGIBLE BREEDS & REGISTRY

Only purebred Afghan Hounds, Azawakhs, Basenjis, Borzoi, Cirneco dell'Etna, Greyhounds, Ibizan Hounds, Irish Wolfhounds, Italian Greyhounds, Pharaoh Hounds, Rhodesian Ridgebacks, Salukis, Scottish Deerhounds, Silken Windhounds, Sloughis, and Whippets..

Limited breeds may be entered in the Limited Stake or the Singles Stake. Limited breeds currently include purebred Chart Polski, Galgo Español, Magyar Agar, Peruvian Inca Orchid, Portuguese Podengo (Pequeno), Portuguese Podengo (Medio & Grande), and must be individually registered with the appropriate registry.

All entries shall be individually registered with the AKC (ILP/PAL included), the NGA, the UKC, the FCI, an ASFA-recognized foreign or ASFA Board approved registry, or possess a CRN from the SPDBS. A photocopy of acceptable registry must be submitted with each hound's first ASFA field trial entry; this requirement is waived for hounds registered with the NGA.

REGULAR STAKES OFFERED

OPEN STAKE: Any eligible sighthound, excluding ASFA Field Champions of record.

FIELD CHAMPION STAKE: Any ASFA Field Champion

VETERAN STAKE: Any eligible hound whose age is at least six years, except Irish Wolfhounds whose age shall be at least five years, and Afghan Hounds, Rhodesian Ridgebacks, Salukis and Whippets whose age shall be at least seven years. Points go toward V-FCh or V-LCM titles.

LIMITED STAKE: Any eligible sighthound of a Limited breed that has met certification requirements. Not eligible to compete in Best of Breed or Best in Field.

SINGLE STAKE: Any eligible sighthound including those disqualified to run in other stakes. Each hound runs alone. Not eligible for Best of Breed or Best in Field. Hounds are eligible to earn TCP and CPS titles from the Singles stake. Limited breeds are not eligible for these titles.

BEST IN FIELD WILL BE OFFERED

Conditions of Entry: All entries must be one year or older on the day of the trial ● Stakes will be split into flights by public random draw if the entry in any regular stake is 20 or more ● Bitches in season, lame hounds and hounds with breed disqualifications will be excused at roll call. ● Spayed, neutered, monorchid or cryptorchid hounds without breed disqualifications may be entered; hounds with breed disqualifications are not eligible to enter except in the Single Stake ● Hounds not present at the time of roll call will be scratched ● All hounds will run twice, in trios if possible or braces (except in the Single Stake), unless excused, dismissed or disqualified.

Equipment: Type of lure machine: battery-powered continuous-loop system. ● Type of lures: highly-visible white plastic strips ● Back-up equipment will be available.

Veterinarian on call:
Central Carroll Animal Emergency
1030 Baltimore Blvd. #180
Westminster, MD 21157
410-871-2000

COURSE PLANS

Saturday 800 yds

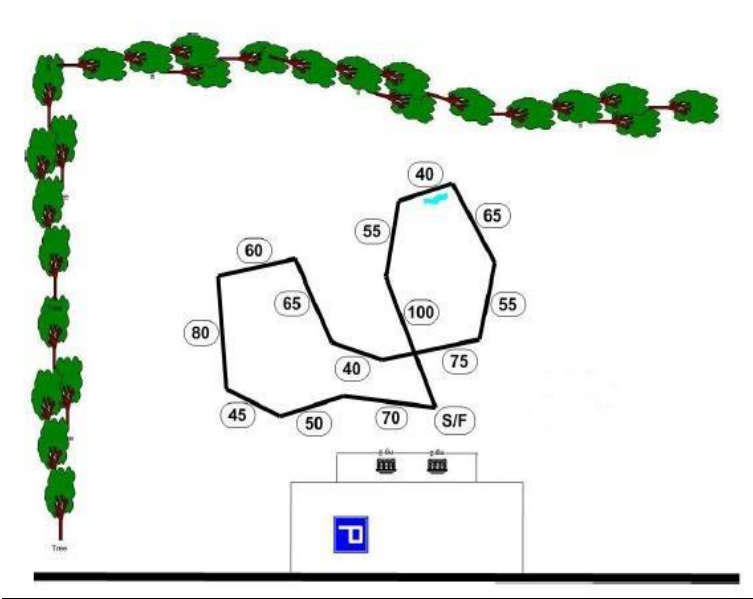

Sunday 760yds

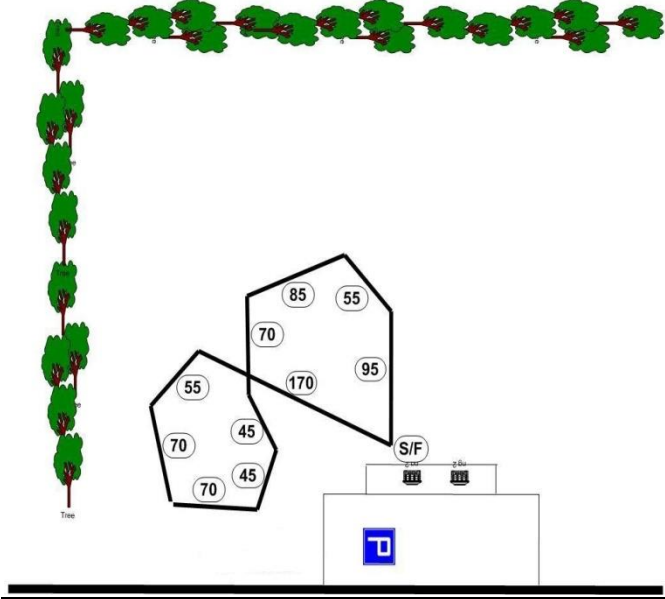

OTHER INFORMATION

- All entries must be one year or older on the day of the trial
 - Stakes will be split into flights by public random draw if the entry in any regular stake is 20 or more
 - Bitches in season, lame hounds and hounds with breed disqualifications will be excused at roll call. Spayed, neutered, monorchid or cryptorchid hounds without breed disqualifications may be entered.
 - Hounds with breed disqualifications are not eligible to enter except in the Single Stake
 - Hounds not present at the time of roll call will be scratched
 - All hounds will run twice, in trios if possible or braces (except in the Single Stake), unless excused, dismissed or disqualified.
- Battery powered, continuous loop lure machines will be used. The lure will consist of white plastic strips. Backup equipment will be available. The course will be reversed for the finals, runoffs and Best of Breed.
- The members of T&HLC reserve the right to alter the course plan as required by weather and/or field conditions on the date of the trial. Exhibitors are requested to not bring bitches known to be in season to the field.

There will be a \$5.00 fine assessed for any loose hound not participating in the course. Any person may, upon reasonable complaint, be asked to leave the grounds of the field trial by the Field Trial Committee.

The field is board fenced; camping is permitted, but there is NO electricity or water. Children must be under control of their parents or guardians at all times.

ALL RETURNED CHECKS WILL BE CHARGED A \$30 FEE.

PLEASE CLEAN UP AFTER YOURSELVES AND YOUR HOUNDS!!!

CERTIFICATIONS will be offered on Saturday after completion of the trial if weather, equipment, daylight, and judges permit. The cost is \$10.00 per hound.

PRACTICE will be offered on Saturday **ONLY, AFTER CERTIFICATIONS**, weather equipment and time permitting. Cost is \$5.00 per run. **LUNCH** will be available for judges and workers.

RV parking is available, no hookups.

OFFICIAL AMERICAN SIGHTHOUND FIELD ASSOCIATION ENTRY FORM

Tortoise & Hare Lure Coursers

Saturday, March 11, 2017

Early entries close **6pm March 9th, 2017** at the FTS's residence.

Early entry fees: **\$18 for the first hound, \$15 for each additional hound**

Day of trial entry fee: **\$25 each hound**

(Substitutions, same owner, until **8am day of trial**)

Make checks payable (in US funds) to **T&HLC** and mail to:

Audrey Silverstein, 3620 Cemetery Lane, Westminster, MD 21158

Fee Paid _____ The Field Secretary cannot accept conditional, unsigned, incomplete or unpaid entries; please check your completed entry carefully.

| | | | |
|--|--|---|---|
| Breed: | | Call Name: | |
| Registered Name of Hound: | | | |
| Stake: <input type="checkbox"/> Open <input type="checkbox"/> FCH <input type="checkbox"/> Veteran <input type="checkbox"/> Single <input type="checkbox"/> Limited | | Additional Stakes: <input type="checkbox"/> Kennel <input type="checkbox"/> Breeder <input type="checkbox"/> Bench | |
| Registration Number: (please write in registering body before number) | | | |
| <input type="checkbox"/> If possible, please separate my hounds | | Date of Birth: | SeS: <input type="checkbox"/> Dog <input type="checkbox"/> Bitch |
| Name of actual owner(s): | | | |
| Address: | | Phone: | |
| City: | | State: | Zip: |
| E-mail (Optional) | | (Optional) Region of Residence: | |
| <input type="checkbox"/> Check if this is the first ASFA trial for this hound. Attach a Hound Certification or waiver if entered in Open, Veterans, Limited. | | | |
| <input type="checkbox"/> Check if this is a first-time entry, a copy of the official Registration of this hound must accompany this entry unless NGA. | | | |
| <input type="checkbox"/> Check if any information has changed since the last ASFA trial entry. Regarding _____ | | | |
| <input type="checkbox"/> Check if this hound has been dismissed within the last 6 trials entered. Must be marked in order to qualify for a "clean" trial requirement. | | | |

I CERTIFY that I am the actual owner of this dog, or that I am the duly authorized agent of the actual owner whose name I have entered above. In consideration of the acceptance of this entry and the opportunity to have this dog judged and to win prize money, ribbons, or trophies, I (we) agree to abide by the rules and regulations of the American Sighthound Field Association in effect at the time of this lure field trial, and by any additional rules and regulations appearing in the premium list for this lure field trial. I (we) agree that the club holding this lure field trial has the right to refuse this entry for cause, which the club shall deem to be sufficient. I (we) agree to hold this club, its members, directors, governors, officers, agents or other functionaries, any employees of the aforementioned parties and the owner(s) of the trial premises or grounds harmless from any claim for loss or injury which may be alleged to have been caused directly or indirectly to any person or thing by the act of this dog while in or upon the lure field trial premises or grounds or near any entrance thereto and I (we) personally assume all responsibility and liability for any such claim, and I (we) further agree to hold the aforementioned parties harmless from any claim loss of this dog by disappearance, theft damage or injury be caused or alleged to be caused by the negligence of the club or any of the aforementioned parties or by the negligence of any person or any other cause or causes. I (we) certify and represent that the dog entered is not a hazard to person or other dogs. This entry is submitted for acceptance of the forgoing representations and agreements

SIGNATURE of owner or his agent
duly authorized to make this entry _____

OFFICIAL AMERICAN SIGHTHOUND FIELD ASSOCIATION ENTRY FORM

Tortoise & Hare Lure Coursers

Sunday, March 12, 2017

Early entries close **6pm March 9th, 2017** at the FTS's residence.

Early entry fees: **\$18 for the first hound, \$15 for each additional hound**

Day of trial entry fee: **\$25 each hound**

(Substitutions, same owner, until **8am day of trial**)

Make checks payable (in US funds) to **T&HLC** and mail to:

Audrey Silverstein, 3620 Cemetery Lane, Westminster, MD 21158

Fee Paid _____ The Field Secretary cannot accept conditional, unsigned, incomplete or unpaid entries; please check your completed entry carefully.

| | | | |
|--|--|---|---|
| Breed: | | Call Name: | |
| Registered Name of Hound: | | | |
| Stake: <input type="checkbox"/> Open <input type="checkbox"/> FCH <input type="checkbox"/> Veteran <input type="checkbox"/> Single <input type="checkbox"/> Limited | | Additional Stakes: <input type="checkbox"/> Kennel <input type="checkbox"/> Breeder <input type="checkbox"/> Bench | |
| Registration Number: (please write in registering body before number) | | | |
| <input type="checkbox"/> If possible, please separate my hounds | | Date of Birth: | SeS: <input type="checkbox"/> Dog <input type="checkbox"/> Bitch |
| Name of actual owner(s): | | | |
| Address: | | Phone: | |
| City: | | State: | Zip: |
| E-mail (Optional) | | (Optional) Region of Residence: | |
| <input type="checkbox"/> Check if this is the first ASFA trial for this hound. Attach a Hound Certification or waiver if entered in Open, Veterans, Limited. | | | |
| <input type="checkbox"/> Check if this is a first-time entry, a copy of the official Registration of this hound must accompany this entry unless NGA. | | | |
| <input type="checkbox"/> Check if any information has changed since the last ASFA trial entry. Regarding _____ | | | |
| <input type="checkbox"/> Check if this hound has been dismissed within the last 6 trials entered. Must be marked in order to qualify for a "clean" trial requirement. | | | |

I CERTIFY that I am the actual owner of this dog, or that I am the duly authorized agent of the actual owner whose name I have entered above. In consideration of the acceptance of this entry and the opportunity to have this dog judged and to win prize money, ribbons, or trophies, I (we) agree to abide by the rules and regulations of the American Sighthound Field Association in effect at the time of this lure field trial, and by any additional rules and regulations appearing in the premium list for this lure field trial. I (we) agree that the club holding this lure field trial has the right to refuse this entry for cause, which the club shall deem to be sufficient. I (we) agree to hold this club, its members, directors, governors, officers, agents or other functionaries, any employees of the aforementioned parties and the owner(s) of the trial premises or grounds harmless from any claim for loss or injury which may be alleged to have been caused directly or indirectly to any person or thing by the act of this dog while in or upon the lure field trial premises or grounds or near any entrance thereto and I (we) personally assume all responsibility and liability for any such claim, and I (we) further agree to hold the aforementioned parties harmless from any claim loss of this dog by disappearance, theft damage or injury be caused or alleged to be caused by the negligence of the club or any of the aforementioned parties or by the negligence of any person or any other cause or causes. I (we) certify and represent that the dog entered is not a hazard to person or other dogs. This entry is submitted for acceptance of the forgoing representations and agreements

SIGNATURE of owner or his agent
duly authorized to make this entry _____

**AMERICAN SIGHTHOUND FIELD ASSOCIATION
HOUND CERTIFICATION**

Rule effective October 1, 1994: Ch. V, Sec. 4 (a) OPEN STAKE: *To be eligible to enter the open stake, a hound must have been certified by a licensed judge within the year preceding the closing date for the entry or have previously competed in the Open Stake.* This eligibility requirement also applies to a hound entered in the Limited or Veteran Stake, which has not competed in Open previously. Please complete this portion of this form and attach it to the entry form for the hound's first entry, including an entry for a Fun Trial.

Registered Name of Hound: _____

Registration Number: _____ Breed: _____

Registered Owner's Name: _____

I hereby certify that on (date) _____, the above named hound completed a lure course of at least 500 yards, running with another hound of the same breed (or another breed with a similar running style). During the course the above named hound showed no inclination to interfere with the other hound. I further certify that I am a licensed judge for the ASFA.

Name of Licensed Judge: _____

Signature: _____ Date: _____

I hereby certify that the hound running in the certification course is the hound identified above and that information provided on this form is true and correct.

Signature: _____ Date: _____

Owner or Authorized Agent of Hound

This certification form must be attached to the entry form the first time this hound is entered in an open, limited, or veteran stake. Any hound entered in open, limited, or veteran (as a first time entered hound), which has not been certified, shall be declared ineligible by the records coordinator and shall forfeit any points and placements awarded.

PLEASE RETAIN A COPY FOR YOUR RECORDS.

**AMERICAN SIGHTHOUND FIELD ASSOCIATION
HOUND CERTIFICATION WAIVER**

Waiver of Requirement: *This requirement will be waived for a hound that has earned a lure coursing or racing title from another recognized organization, if such title requires competition, and if a waiver for such title has been approved by the ASFA, or a CKC Hound Certification Form.* If your hound qualifies for a waiver, complete this portion of this form and attach it to your entry form. Proof of waivers must accompany this certification form.

Registered Name of Hound: _____

Registration Number: _____ Breed: _____

Registered Owner's Name: _____

CKC: FCH FCHS **CWA:** ARS TRP SRA DPC

AKC: QC SC FC **LGRA:** GRC **NAWRA:** RCH SR

WRA: CR WRCH **NOTRA:** ORC OTR SORC SOR

Hound Certification previously submitted.

I hereby certify that the hound identified above has completed the requirements for the title indicated above (or that the required Certification was previously submitted) and that the information provided on this form is true and correct.

Signature: _____ Date: _____

Owner or Authorized Agent of Hound

**AMERICAN SIGHTHOUND FIELD ASSOCIATION
HOUND CERTIFICATION**

Rule effective October 1, 1994: Ch. V, Sec. 4 (a) OPEN STAKE: *To be eligible to enter the open stake, a hound must have been certified by a licensed judge within the year preceding the closing date for the entry or have previously competed in the Open Stake.* This eligibility requirement also applies to a hound entered in the Limited or Veteran Stake, which has not competed in Open previously. Please complete this portion of this form and attach it to the entry form for the hound's first entry, including an entry for a Fun Trial.

Registered Name of Hound: _____

Registration Number: _____ Breed: _____

Registered Owner's Name: _____

I hereby certify that on (date) _____, the above named hound completed a lure course of at least 500 yards, running with another hound of the same breed (or another breed with a similar running style). During the course the above named hound showed no inclination to interfere with the other hound. I further certify that I am a licensed judge for the ASFA.

Name of Licensed Judge: _____

Signature: _____ Date: _____

I hereby certify that the hound running in the certification course is the hound identified above and that information provided on this form is true and correct.

Signature: _____ Date: _____

Owner or Authorized Agent of Hound

This certification form must be attached to the entry form the first time this hound is entered in an open, limited, or veteran stake. Any hound entered in open, limited, or veteran (as a first time entered hound), which has not been certified, shall be declared ineligible by the records coordinator and shall forfeit any points and placements awarded.

PLEASE RETAIN A COPY FOR YOUR RECORDS.

**AMERICAN SIGHTHOUND FIELD ASSOCIATION
HOUND CERTIFICATION WAIVER**

Waiver of Requirement: *This requirement will be waived for a hound that has earned a lure coursing or racing title from another recognized organization, if such title requires competition, and if a waiver for such title has been approved by the ASFA, or a CKC Hound Certification Form.* If your hound qualifies for a waiver, complete this portion of this form and attach it to your entry form. Proof of waivers must accompany this certification form.

Registered Name of Hound: _____

Registration Number: _____ Breed: _____

Registered Owner's Name: _____

CKC: FCH FCHS **CWA:** ARS TRP SRA DPC

AKC: QC SC FC **LGRA:** GRC **NAWRA:** RCH SR

WRA: CR WRCH **NOTRA:** ORC OTR SORC SOR

Hound Certification previously submitted.

I hereby certify that the hound identified above has completed the requirements for the title indicated above (or that the required Certification was previously submitted) and that the information provided on this form is true and correct.

Signature: _____ Date: _____

Owner or Authorized Agent of Hound